

INSTALLATION MANUAL

SUPPORT DISPLAY CABINET

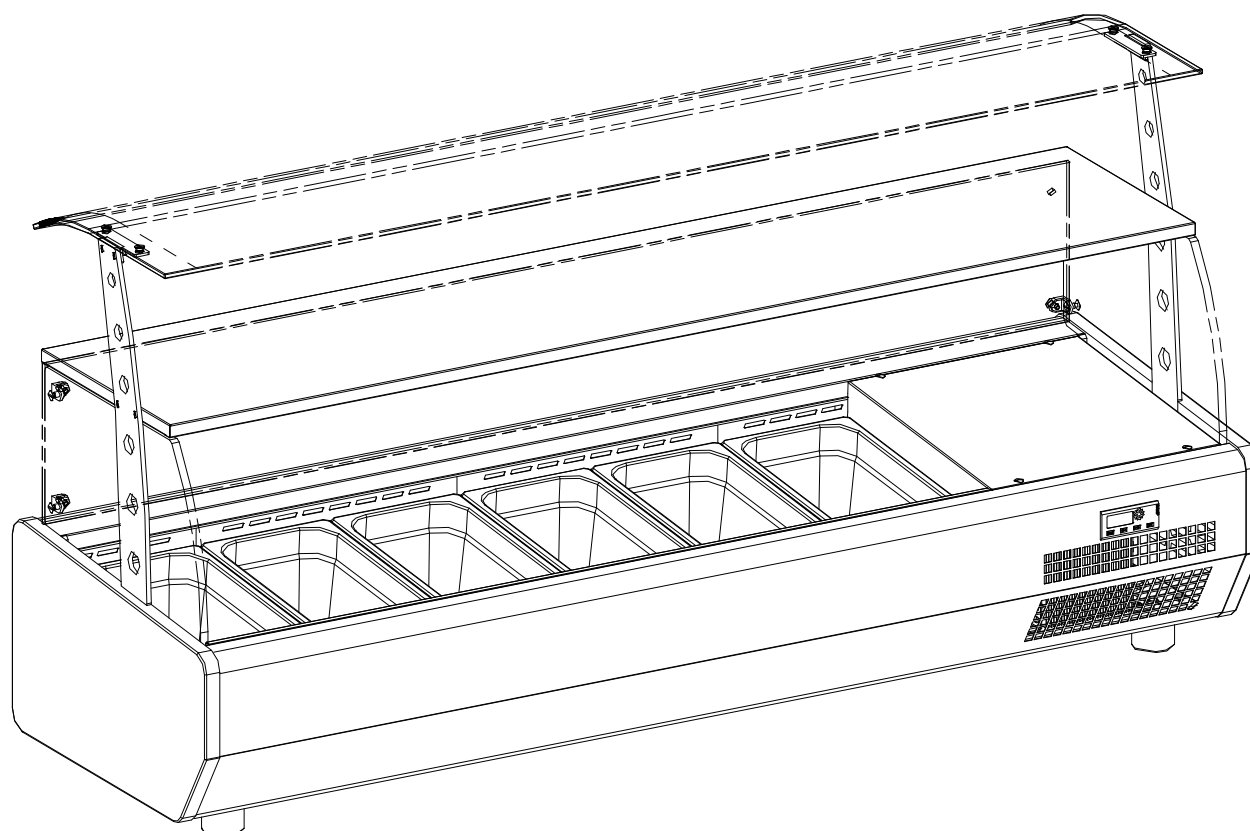

Elaborated by:

Approved by:

Edition: 1

Fausto Gonçalves

Luís Basto

26/10/2005

Index

1.	Introduction	3
2.	General Concepts.....	4
2.1.	Helpful hints for the user	4
2.2.	Installation	5
3.	Models	6
3.1.	Ventilated.....	6
3.2.	Static	7
4.	General Characteristics.....	8
4.1.	Static	8
4.2.	Ventilated.....	8
5.	Climate Class Table.....	8
6.	Electrical Wiring Diagram.....	9
6.1.	Static	9
6.1.	Ventilated.....	10
7.	Programming the Thermostat	11
7.1.	Static	11
7.2.	Ventilated.....	12
8.	Main replaceable parts.....	13
8.1.	Static Support Display Cabinet.....	13
8.1.1.	Acrylic Cover for Static Display Cabinet	14
8.1.2.	Straight Glasses for Static Support Display Cabinet.....	15
8.2.	Ventilated Support Display Cabinet	16
8.2.1.	Acrylic Cover for Ventilated Support Display Cabinet	17
8.2.2.	Curved Glass for Ventilated Support Display Cabinet	18
8.2.3.	Self Glass with Shelf for Ventilated Support Display Cabinet	19

1. INTRODUCTION

Our Quality Policy is orientated towards the ***“creation of products that satisfy the customers' real needs, providing an excellent service.”***

We have created installation manuals for all our products, in which our customers will find useful information that is indispensable for the correct installation and maintenance of these appliances. Therefore we recommend that you read this manual carefully so as to assimilate all the information it contains correctly. **Whenever you receive any alteration/update** immediately substitute the manual, totally or partially, according to our instructions. Keep the original and any copies up to date. **Do not forget that the manuals are indispensable for proper installation and maintenance of the equipment.**

For technical assistance always request the components you need by their respective code and designation (consult from point 8 onwards).

2. GENERAL CONCEPTS

2.1. HELPFUL HINTS FOR THE USER

- **Regularly restock** the appliance(s) with products so as to avoid their large-scale entrance at any time. Do not place products beyond the defined **load limits** for each case. Remember that the products should be placed at a **temperature close** to that of use and that the appliances are for conservation and not for cooling. Do **not obstruct** air outlet grills next to the evaporating unit or suction grills.
- Check periodically that the **power fans**, when equipped, are all fully **working**. Call for technical assistance in the event of these not working because they are essential for a good circulation of air inside the appliance. Do not obstruct the power fans when restocking with products.
- Conduct a periodic **cleaning** of the **condensing unit** (at least once a month) because the performance is greatly improved and the energy consumption reduced. Always keep the ventilation grills and the space surrounding the compressor groups unimpeded.
- Check that the **power fans** are working. In the event of them non-functioning, disconnect the appliance from the current immediately to avoid burning-out the compressor, and call technical assistance to solve the problem.
- Check regularly if the **evaporating unit** is blocked or not. If it is, proceed with a manual defrost. If the problem persists call technical assistance.
- Check the state of conservation of the **plug and power socket** regularly, paying attention to any excessive heating.
- When doing any cleaning, **disconnect** the appliance from the electrical power supply.
- **Always** keep the appliance(s) **clean and dry**, both inside and out. Only clean it with water and a **neutral detergent** and do not wet the electric or electronic parts. Apart from having a more hygienic appearance, it will guarantee better operation and durability.
- Do not use **abrasive** products (e.g. chlorine based solvents and scotch-brite cleaning pads). The use of these can damage the protective coating of the appliance(s) and contribute to a more rapid corrosion.
- Do not use **steam** or **high pressure** water for cleaning.
- Regularly **clean** the **run-off channels** for melt water. Do not allow residues, particularly blood, pieces of meat and milk, to remain for a long time in its inside, since these will provoke smells and will contribute to **corrosion**.

2.2. INSTALLATION

- Install the appliance(s) in **unimpeded areas**, far away from sources of heat, draughts, radiators, the sun's rays, ovens, outlets of air-conditioning, fans, etc. and protected from rain. Never install in an environment with temperatures above **30 °C**. The relative humidity of the air should be equal to or lower than 60%. For higher temperatures the appliances will have to be equipped with compressor groups suitable for the tropics.
- Install appliance(s) far away from **dangerous environments** where there is risk of fire, radiation or explosion.
- Maintain the surrounding **areas unimpeded** and verify that the ventilation grills are not obstructed.
- Any adverse conditions will **affect** the performance of the appliance and they will provoke a significant **increase** in **energy** consumption.
- Connect the appliance in accordance with the specific instructions for each (**230 V and 50 Hz**). Verify that the power socket has an **earth wire** because it is compulsory by law.
- Before placing products in the appliance(s) the equipment should have been **running** for at least **one hour** with the curtains lowered, lights out, closed doors, etc. according to each product.
- Our products carry the CE mark, which guarantees that all the safety norms have been taken in consideration.

3. MODELS

3.1. VENTILATED

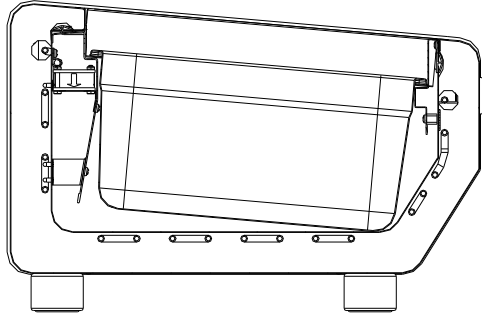

Ventilated Support Display Cabinet

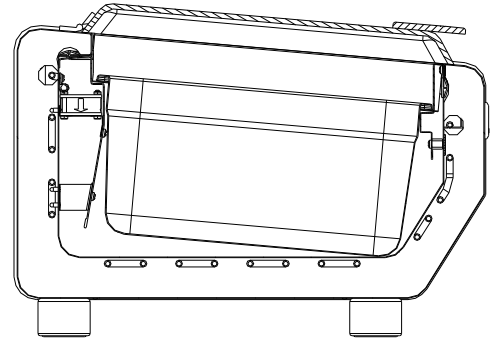

Ventilated Support Display Cabinet
With Acrylic Cover

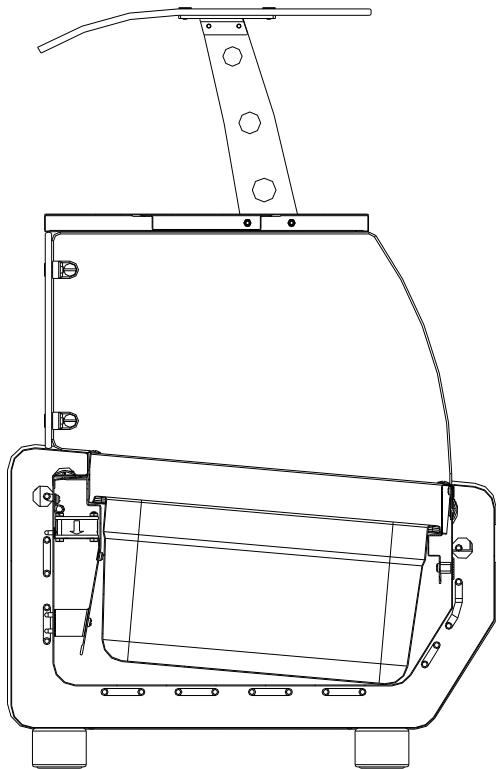

Ventilated Support Display Cabinet
With Self Glass With Shelf

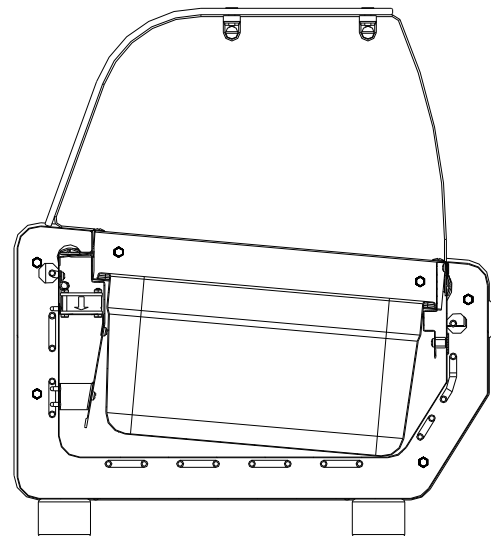

Ventilated Support Display Cabinet
With Curved Glass

3.2. STATIC

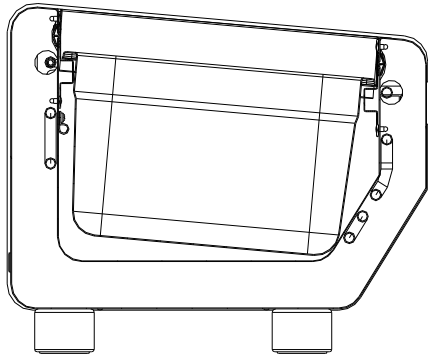

Static Support Display Cabinet

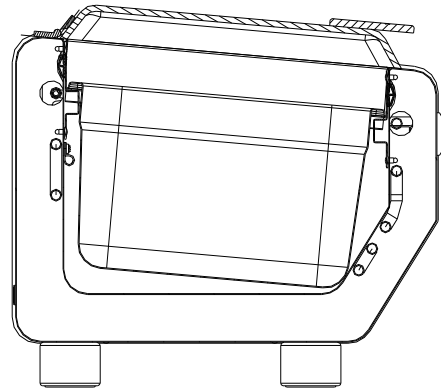

Static Support Display Cabinet
With Acrylic Cover

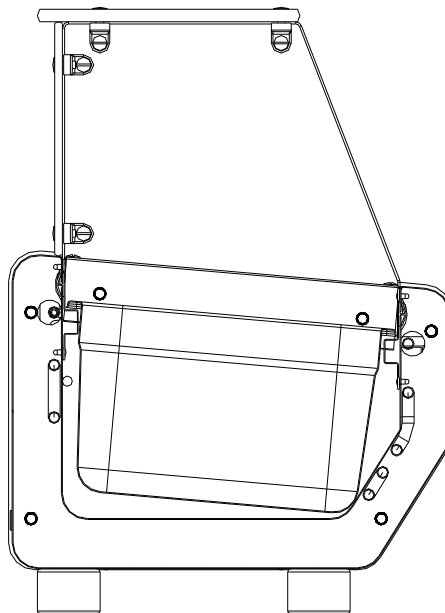

Static Support Display Cabinet
With Straight Glass

4. GENERAL CHARACTERISTICS

- This is a multi-functional display and of free installation. As an option you can place it over 800 Counter Plus with pizza cover.
- The refrigerating system can be either static or ventilated in the chamber.
- The glasses are available according to the chosen version.
- Although it is optional, it is very important that packing is provided, since this guarantees that none of the equipment will get damaged during transport.
- Cold and defrost cycles are controlled by an electronic control device with digital display.

4.1. STATIC

- Prepared for placing gastronomic containers with 354mm or GN $1/2$

4.2. VENTILATED

- Prepared for placing gastronomic containers with 454mm or GN 1/1 longitudinal.

5. CLIMATE CLASS TABLE.

Appliance	Temperature (°C)	Climate Class
Static / Ventilated Display Cabinet c	2 / 5	3M1

6. ELECTRICAL WIRING DIAGRAM

6.1. STATIC.

Static Refrigerated Support Display Cabinet 1430 (2P) / 1925 (3P)

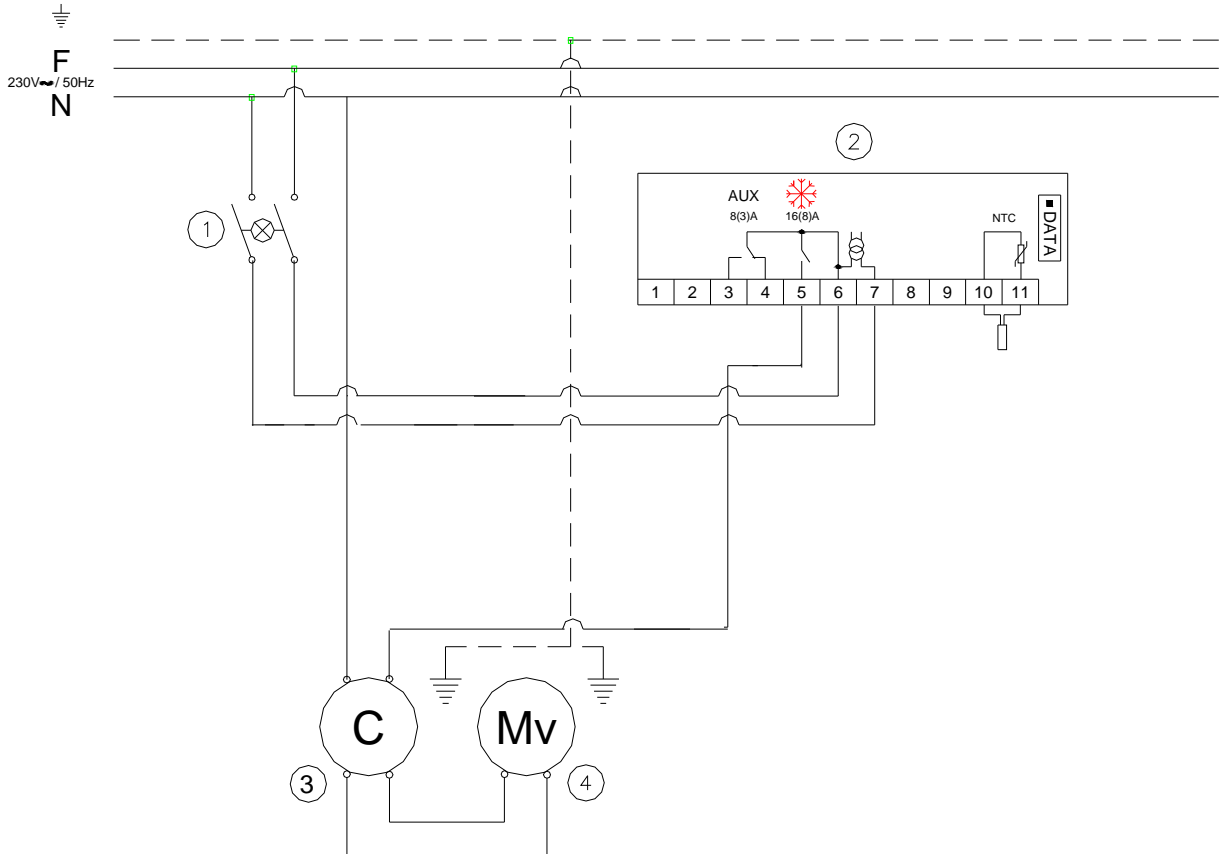

Key

- 1 – Main switch with indicator
- 2 – Digital control unit
- 3 – Compressor
- 4 – Compressor Fan

6.1. VENTILATED.

Ventilated Refrigerated Support Display Cabinet
1430 (2P) / 1925 (3P)

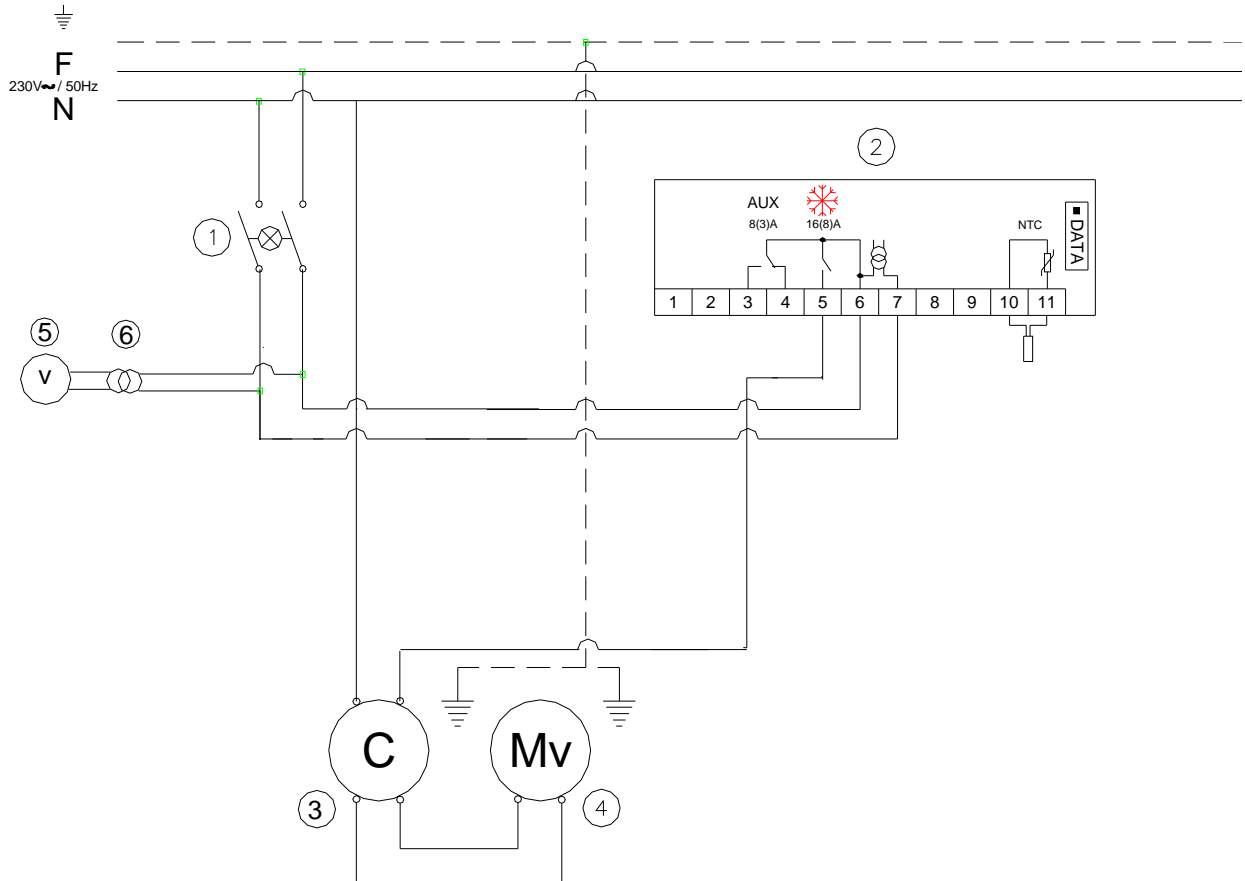

Key

- | | |
|--------------------------------|-------------------------------|
| 1 – Main switch with indicator | 5 – Ventilator |
| 2 – Digital control unit | 6 – Transformer 230V~ / 12V ~ |
| 3 – Compressor | |
| 4 – Compressor Fan | |

7. PROGRAMMING THE THERMOSTAT

7.1. STATIC

CONTROLLER LAE LDU 152-E-AS

CONFIGURATION

Cut-out temperature 2.0

STATIC SUPPORT DISPLAY CABINET

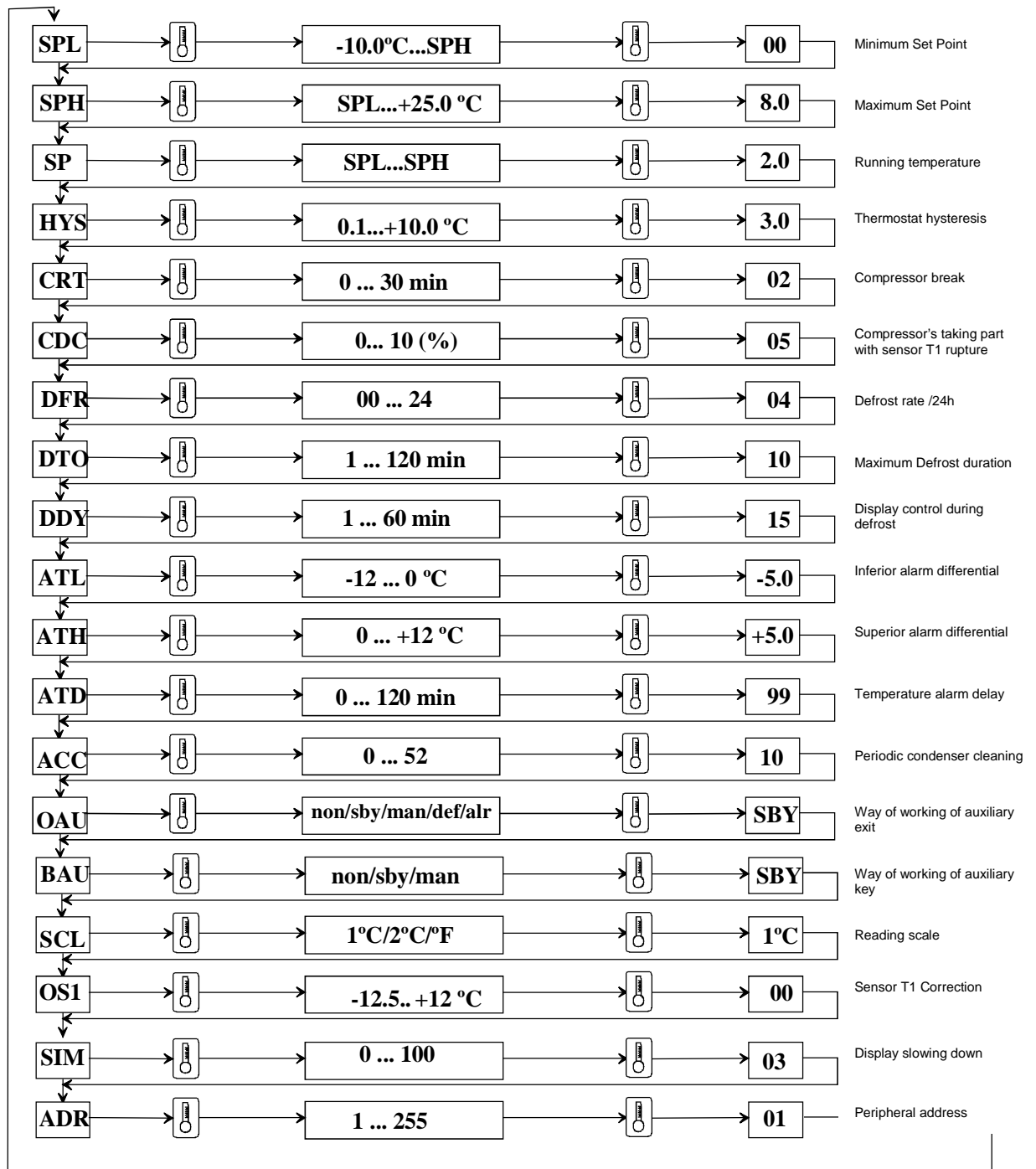

7.2. VENTILATED

CONTROLER LAE LDU 152-E-AS

CONFIGURATION

Cut-out temperature 2.0

VENTILATED SUPPORT DISPLAY CABINET



8. MAIN REPLACEABLE PARTS

8.1. STATIC SUPPORT DISPLAY CABINET

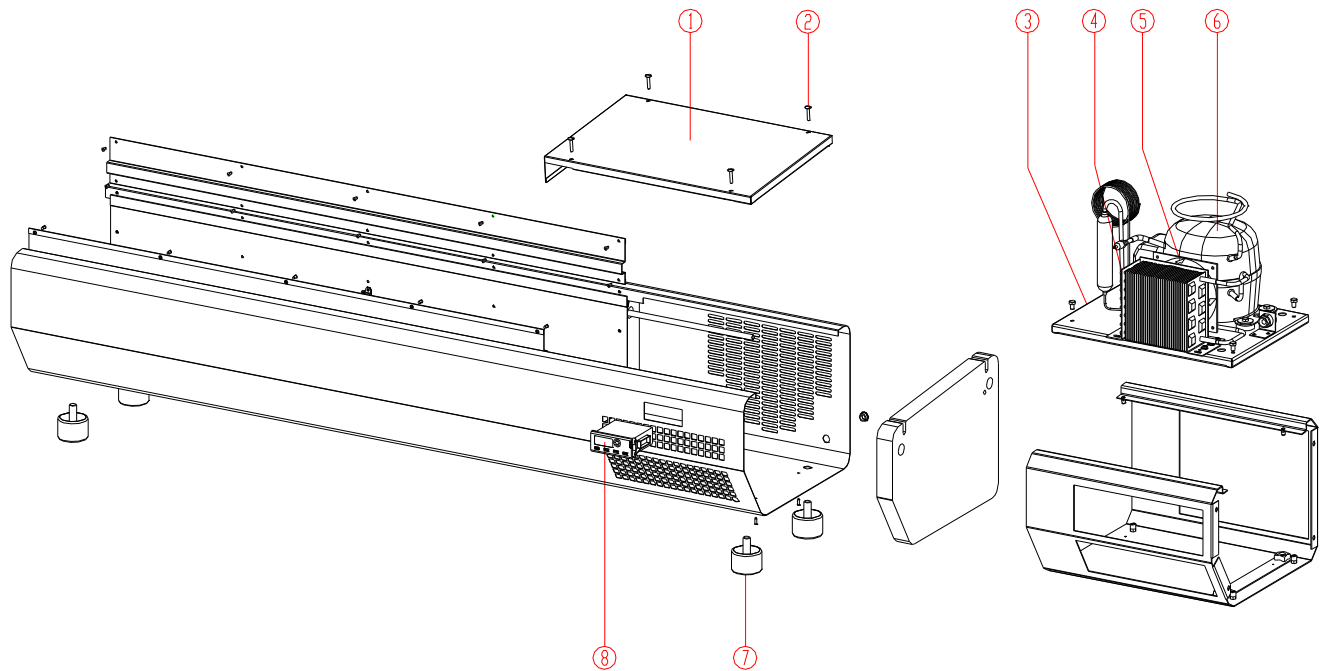

N°	CODE	DESIGNAITON	1430 (2P)	1925 (3P)
1	SC90710000	GROUP COVER STATIC SUPPORT DISPLAY CABINET		•
2	MS30001406	SUPPRT SHELF SUPPORT SCREW M5X18		•
3	IC17510003	COMPRESSOR GROUP STATIC SUPPORT DISPLAY CABINET		•
4	MS40000099	CONDENS.LU-VE STFT/COND/8T2125A/FEFE-90		•
5	MS40000452	VENTIL.SUNON DP200A-212 3XSL 120X120X38		•
6	MS40000384	HERMETIC COMPRESSOR LH AZ1330Y (R134A)		•
7	IC90010000	4 SMALL FEET KIT F/ SUPPORT DISPLAY CABINET		•
	MS30000143	STAINLESS STEEL FOOT 50X37 W/SPINDLE M12		•
8	MS40000095	DIGITAL CONTROL UNIT LDU152E-AS - W/GENERAL SWITCH		•
	MS40000430	SENSOR F/CONTROL UNIT LDU152E SN2K20P1		•

8.1.1. ACRYLIC COVER FOR STATIC DISPLAY CABINET

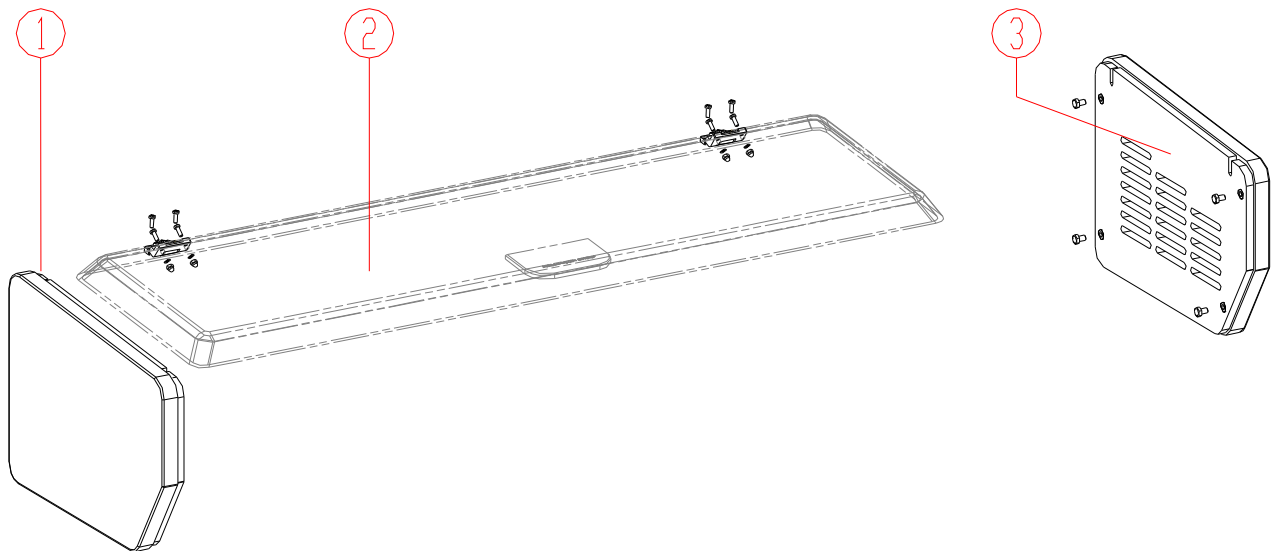

N°	CODE	DESIGNAITON	1430 (2P)	1925 (3P)
1	SC19610000	LEFT LAT. ACRYLIC COVER STATIC SUPPORT DISPLAY CAB.		•
2	IC78710002	ACRYLIC COVER KIT. STATIC SUPPORT DISPLAY CABINET	•	
	IC78710003	ACRYLIC COVER KIT STATIC SUPPORT DISPLAY CABINET 3P		•
	MS61000072	ACRYLIC COVER STATIC SUP.DISP.CAB.2P (1430) (WO/HINGE)	•	
	MS61000073	ACRYLIC COVER STATIC SUP.DISP.CAB.3P (1925) (WO/HINGE)		•
3	IC19610001	RIGHT LAT. ACRYLIC COVER STATIC SUPPORT DISPLAY CAB		•

8.1.2. STRAIGHT GLASSES FOR STATIC SUPPORT DISPLAY CABINET

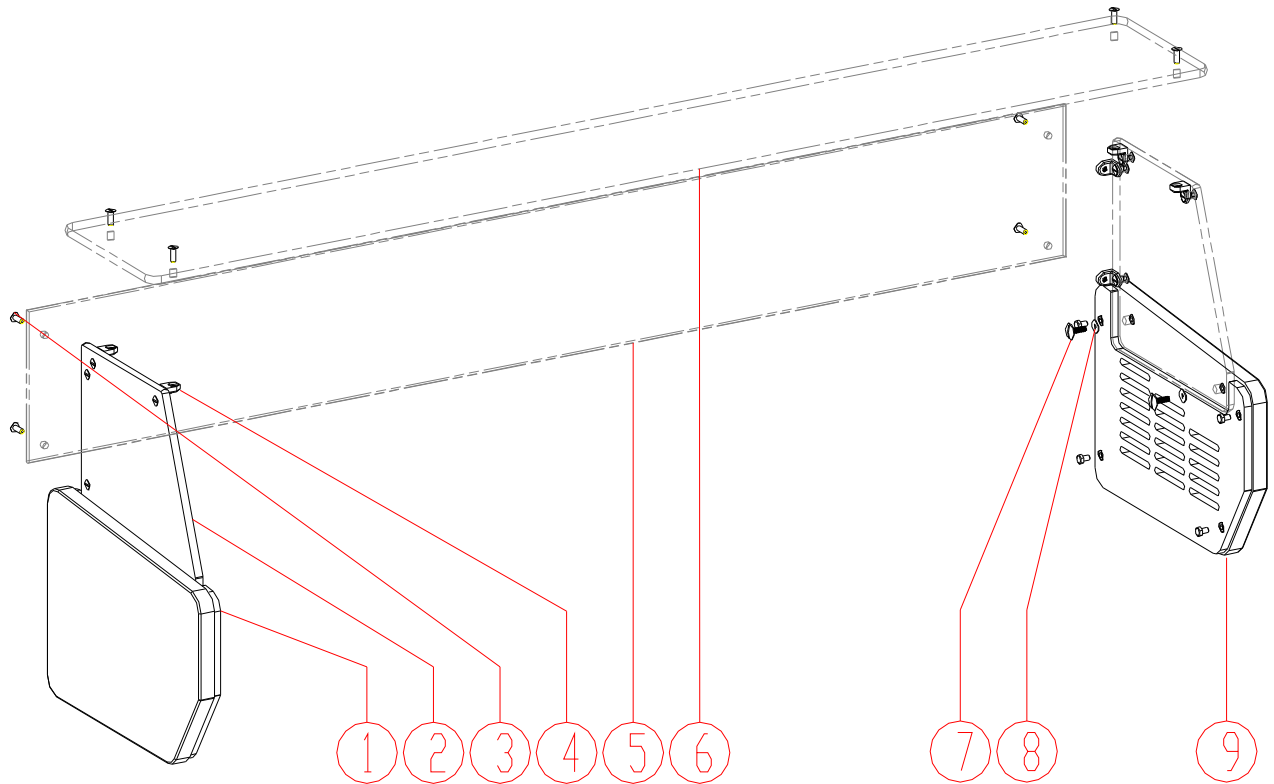

Nº	CODE	DESIGNAITON	1430 (2P)	1925 (3P)
1	IC19510000	LEFT LAT. STATIC SUPPORT DISPL.CAB.STRAIGHT GLASSES		•
2	MS60000060	RIGHT LAT.GLASSES STATIC SUPPORT DISPL.CABINET		•
3	MS34000039	LAT.GLASS FIX.S/STEEL SCREW W/GLASS COVER M6X17		•
4	MS34000034	FIX.SPANGLE FRONT GLASS DIVERSE		•
5	MS60000058	RIGHT FRONT GLASS STATIC SUPPORT DISPLAY CABINET 2P	•	
	MS60000059	RIGHT FRONT GLASS STATIC SUPPORT DISPLAY CABINET 3P		•
6	MS60000056	RIGHT GLASS SHELF STATIC SUPPORT DISPLAY CABINET 2P	•	
	MS60000057	RIGHT GLASS SHELF STATIC SUPPORT DISPLAY CABINET 3P		•
7	MS30001092	SCREW W/SWIVEL –LAT. GLASS FIX. MUR.FUND.		•
8	MS30001021	FIXATION SWIVEL FRONT GLASS DIVERSE		•
9	IC19510001	RIGHT LAT. STATIC SUPP DISPL.CAB. STRAIGHT GLASSES		•

8.2. VENTILATED SUPPORT DISPLAY CABINET

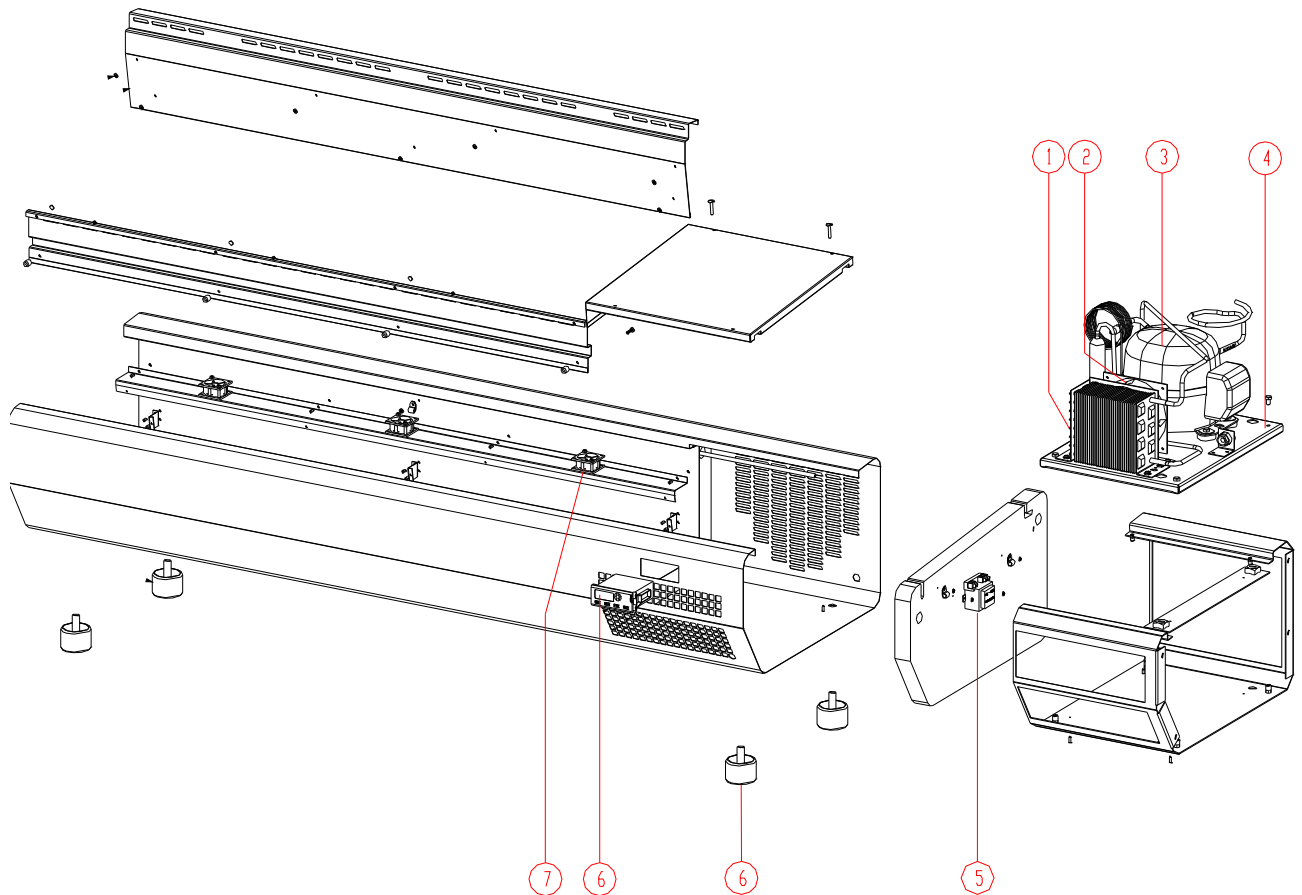

N°	CODE	DESIGNAITON	1430 (2P)	1925 (3P)
1	MS40000099	CONDENS.LU-VE STFT/COND/8T2125A/FEFE-90		•
2	MS40000384	HERMETIC COMPRESSOR LH AZ1330Y (R134A)		•
3	MS40000452	VENTIL.SUNON DP200A-212 3XSL 120X120X38		•
4	IC17010003	COMPRESSOR GROUP VENTIL. SUPPORT DISPLAY CAB.2P/3P		•
5	MS40000027	TRANSFORMER P.M.A 153/M (230V/12V)		•
6	IC90010000	4 SMALL FEET F/SUPPORT DISPLAY CABINET		•
	MS30000143	STAINLESS STEEL FOOT 50X37 W/SPINDLE M12		•
7	MS40000095	DIG.CONTROL UNIT LDU152E-AS - W/GENERAL SWITCH		•
	MS40000430	SENSOR F/CONTROL UNIT LDU152E SN2K20P1		•
8	MS40000467	VENTILATOR PIZZA SUPPORT DISPLAY CABINET	3	4

8.2.1. ACRYLIC COVER FOR VENTILATED SUPPORT DISPLAY CABINET

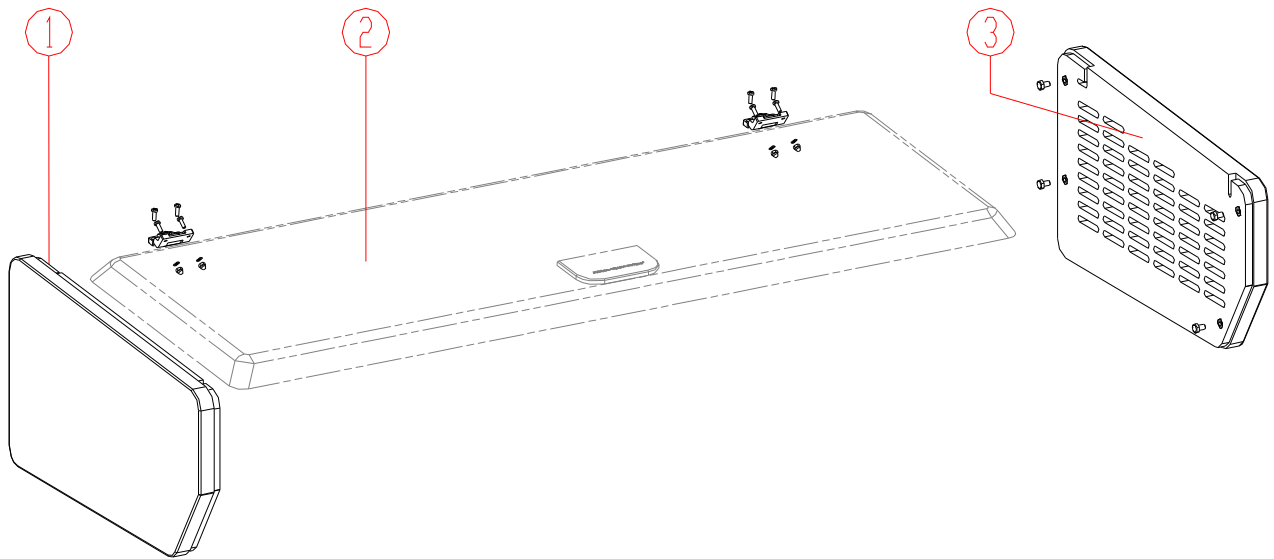

N°	CODE	DESIGNAITON	1430 (2P)	1925 (3P)
1	SC19210000	LEFT LAT. VENT.SUPPORT DISPL.CAB.ACRYLIC COVER		•
2	IC78210002	ACRYLIC COVER KIT VENT.SUPP.DISPL.CAB. 2P 1430	•	
	IC78210003	ACRYLIC COVER KIT VENT.SUPP.DISPL.CAB. 3P 1925		•
	MS61000070	ACRYLIC COV.KIT VENT.SUPP.DISPL.CAB.2P (1430) (W/HINGE)	•	
	MS61000071	ACRYLIC COV.KIT VENT.SUPP.DISPL.CAB.3P (1925) (W/HINGE)		•
3	IC19210001	RIGHT LAT. VENT.SUPPORT DISPL.CAB.ACRYLIC COVER		•

8.2.2. CURVED GLASS FOR VENTILATED SUPPORT DISPLAY CABINET

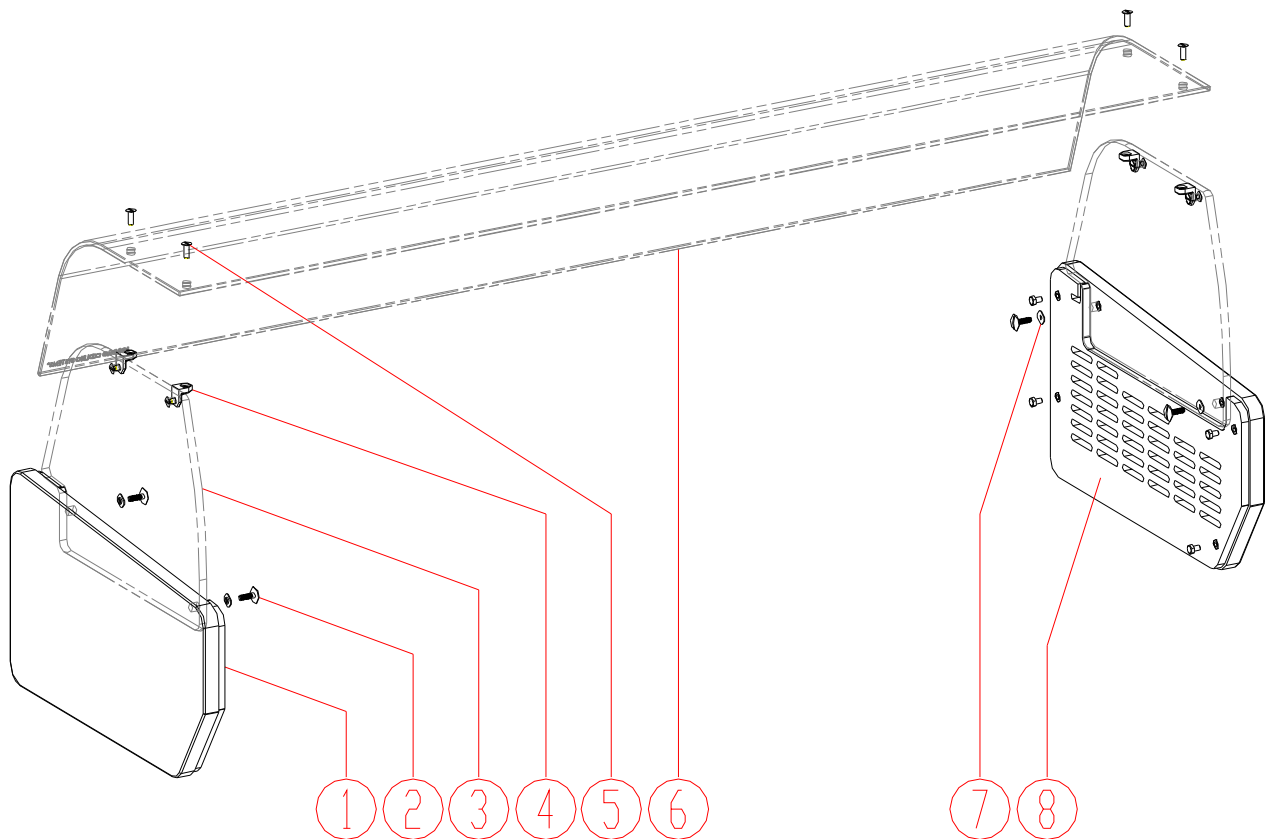

N°	CODE	DESIGNAITON	1430 (2P)	1925 (3P)
1	IC19110000	LEFT LAT. VENT.SUPPORT DISPL.CAB.CURVED GLASSES		•
2	MS30001092	SCREW W/SWIVEL –LAT GLASS FIX. MUR.FUND.		•
3	MS60000044	LATERAL CURVED GLASS VENT.SUPP.DISPL.CABINET		•
4	MS34000034	FIX.SPANGLE FRONT GLASS DIVERSE		•
5	MS34000039	LAT.GLASS FIX.S/STEEL SCREW W/GLASS COVER M6X17		•
6	MS60000042	CURVED FRONT GLASS VENT.SUPPORT DISPL.CAB. 2P	•	
	MS60000043	CURVED FRONT GLASS VENT.SUPPORT DISPL.CAB. 3P		•
7	MS30001021	FIX. SWIVEL FRONT GLASS DIVERSE		•
8	IC19110001	RIGHT LAT. VENT.SUPPORT DISPL.CAB.CURVED GLASSES		•

8.2.3. SELF GLASS WITH SHELF FOR VENTILATED SUPPORT DISPLAY CABINET

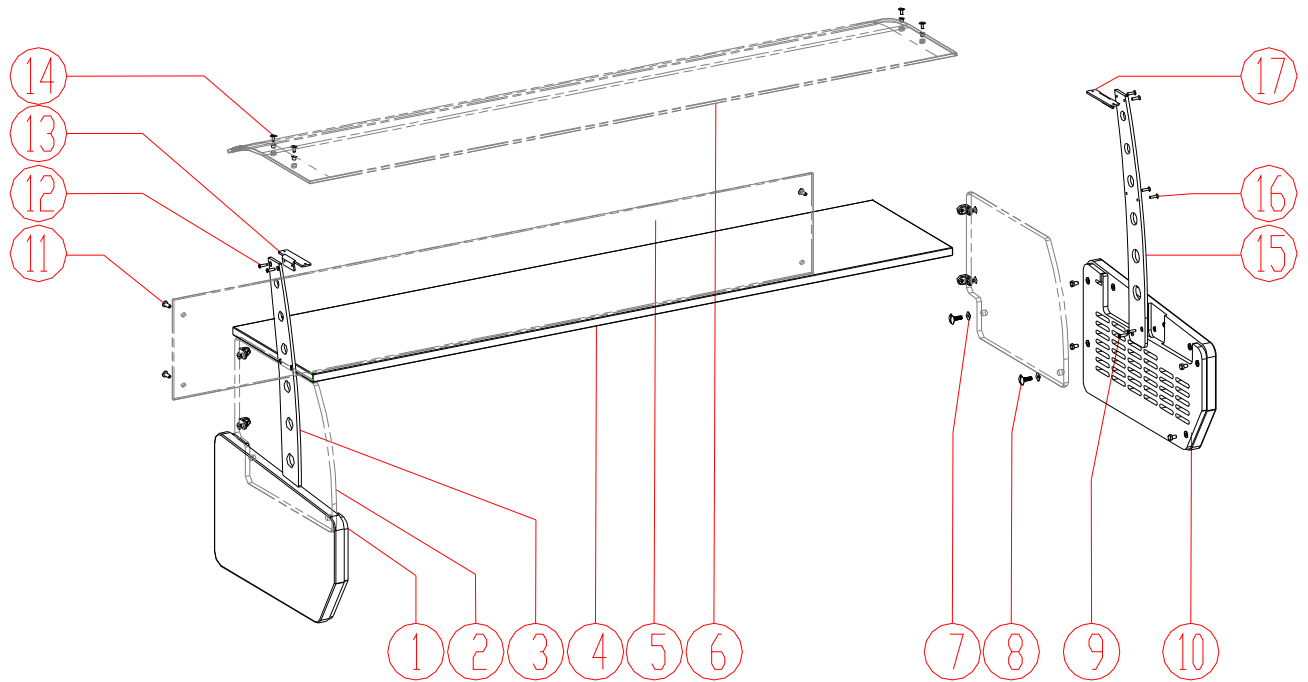

N°	CODE	DESIGNAITON	1430 (2P)	1925 (3P)
1	IC19010000	LEFT LAT. VENT.SUPPORT DISPL.CAB.SELF GLASS W/SHELF	•	
2	MS60000038	LAT.GLASS VENT.SUPPORT DISPL.CAB.SELF GLASS W/SHELF	•	
3	MS30000217	LEFT ARM REFRIGERATED SUPPORT DISPLAY CABINET		•
4	IC40010002	INTERM.STEEL SHELF VENT.SUPPORT DISPL.CAB.2P(1430)	•	
	IC40010003	INTERM.STEEL SHELF VENT.SUPPORT DISPL.CAB.3P(1925)		•
5	MS60000039	RIGHT FRONT GLASS VENT.SUPPORT.DISPL.CAB.2P	•	
	MS60000040	RIGHT FRONT GLASS VENT.SUPPORT.DISPL.CAB.3P		•
6	MS60000036	CURVED SELF GLASS VENT.SUPPORT.DISPL.CAB.2P	•	
	MS60000037	CURVED SELF GLASS VENT.SUPPORT.DISPL.CAB.3P		•
7	MS30001021	FIX. SWIVEL FRONT GLASS DIVERSE		•
8	MS30001092	SCREW W/SWIVEL –LAT GLASS FIX. MUR.FUND.		•
9	MS30001634	SCREW.UNBRAKO W/CON.M4X16 DIN 7991 S/LESS STEEL		•
10	IC19010001	RIGHT LAT. VENT.SUPPORT DISPL.CAB.SELF GLASS W/SHELF		•
11	MS34000039	LAT.GLASS FIX.S/STEEL SCREW W/GLASS COVER M6X17		•
12	MS30001634	SCREW UNBRAKO W/CON.M4X16 DIN 7991 S/LESS STEEL		•
13	MS30000266	UPPER LEFT SHELF SUPPORT SUPP.DISPL.CAB.		•
14	MS34000038	LAT.GLASS FIX.S/STEEL SCREW W/GLASS COVER M4X10		•
15	MS30000218	RIGHT ARM REFRIGERATED SUPPORT DISPLAY CABINET		•
16	MS30001634	SCREW UNBRAKO W/CON.M4X16 DIN 7991 S/LESS STEEL		•
17	MS30000267	UP.RIGHT SUPP.GLASS SELF W/SHELF VENT.SUP.DISPL.CAB.		•